

PET LOADER H20 ASSEMBLY INSTRUCTIONS – 3 STEP

The Pet Loader comes to you partially assembled and with all the hardware to complete the assembly and installation on the boat. These assembly instructions will guide you through the assembly of the steps. Tools you will need are;

- 1/4 Allen wrench – supplied
- 9/16 open end wrench or pliers

- 1) First open the box and lay out all contents on a flat surface. Be sure to check that you have all the items noted on the parts list. Please note that since the Pet Loader is partially assembled so some of these components will not be packaged separately in the box.

ITEM NO.	PART DESCRIPTION	Default/QTY.
1	Boat Deck H2O Petloader as shipped	1
2	7.5625x19.75 Step	1
3	Boat Mount Left Bracket	1
4	Boat Mount Right Bracket	1
5	Rubber Mount Gasket	4
6	Mount Plate	2
7	Short Brace	2
8	9x18 Step	1
9	18x24 Platform	1
10	Brace Bar	2
11	Spacer Washer – 3/8	4
12	3/8 SHCS x 1.250	6
13	3/8 Washer	26
14	3/8 SHCS x 1.000	2
15	3/8 Locking Hexnut	10
16	3/8 Hex Bolt x 2.50	4
17-20	Position Pins, Pin Mounting Brackets and Cable Assy.	4
21	10-24 PH-CR x .750	2
22	10-24 Locking Hexnut	4
	Allen wrench	1
	3/8 SHCS x .75	4
	3/8 Locking Acorn Nut	2

- 2) For installation of the Pet Loader boat brackets to the boat please refer to the installation instructions provided. It may be helpful to separate the parts required for the installation to the boat from those needed to complete the steps assembly. Installation of the brackets to the boat will require Items #3, #4, #5, #6, #16, four of # 15 and 8 of #13.
- 3) To complete the assembly of the Pet Loader please follow these step by step instructions (Pictures as shown are for reference. Some models may vary).

- a. Remove the first step item #8 (9x18) and lay to the side on a flat surface. You will notice that on each side of the step the short braces have been pre-assembled for your convenience. We will come back to this later.



- b. Remove the two step assembly (landing 18x 24 step and second step 9 x18) which is partially assembled.

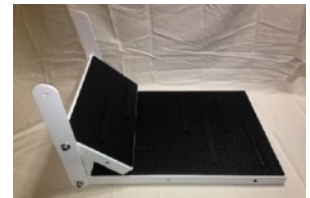

- c. Remove the two long brace bars (item number 10) and lay them with the smooth part of the bolts facing up. One will be the left side and the other the right. In this figure the left side (as you face the back of the boat – port side) is on the bottom. Please note that as you look at the bars with the smooth side of the bolt facing you, if the three hole pattern is to your left then it is the left brace bar. If the three hole pattern is to your right then that is the right brace bar.



- d. Notice that the bars have three holes at one end. Be careful to assemble the brace bars with the single hole on the top. Refer to figures below.



- e. The hardware for your Pet Loader has been assembled in small bags holding the parts you will need for each step. Locate the package - A - that has four one inch long 3/8 inch bolts. These will be used to assemble the long brace bars to the partially assembled landing and second step.



- f. Each location noted by the - A - arrows will require a bolt, two washers, one nut and one spacer. These will be used to attach the long brace bars to the two step assembly shown in 3.b. Each bar will require two sets of hardware.



- g. Place a washer onto the bolt and slide it to the head of the bolt. It should look like this. Place the bolt through the lowest hole in the left brace bar then slide a spacer onto the bolt. Now push the bolt through the hole in the left side of the landing step



as shown. From the underside of the step place a washer and then the nut on the bolt and tighten slightly. Repeat this for the other three – A - locations.

- h. Locate the small bag - B - with two 1-1/4 inch 3/8 bolts. These will be used in the two - B - locations, one on each side. Slide the washer onto the bolt then push it through the brace bar, and then the step while holding the step in place. From the underside of the step add a washer and nut, tighten slightly. Repeat this for the other side. The assembly should look like this.

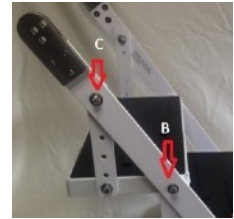

- i. Locate the small bag - C - with two one inch long 3/8 inch bolts, two acorn nuts and four washers. These will be used in the –C- locations.

- j. On each side of the step are short braces that came preassembled. Take each and lift it in place until the hole in the end of the brace align with the hole in the side bar as shown in location - C -. Install the bolt and washer through the brackets and on the back side add a washer and acorn nut. Repeat for the right side. The assembly should look like this. Be sure that the acorn nut is to the inside the brace bar.



of

- 4) With the Pet Loader on a flat surface check to make sure that the steps and bars look in place and square. Tighten all bolts using the supplied allen wrench and an open end wrench or pliers. The assembly is now complete.



- 5) Once the Pet Loader has been assembled and the brackets (items #3 and #4) installed on the boat then install step item # 2 between the brackets using the 3/8 by 3/4 long bolts. Install all four bolts through the brackets and into the nuts installed on the sides of the step and tighten.



four

Questions? Please call 877 275 4870 toll free or email us at www.petloader.com

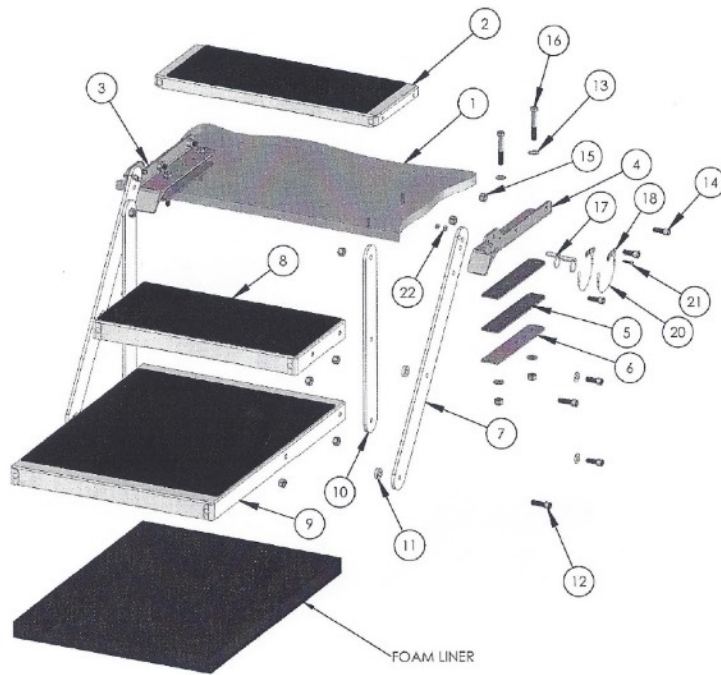

ITEM NO.	PART DESCRIPTION	Default/Qty.
1	Boat Deck	1
2	2.5625x19.75 Step	1
3	Boat Mount Left Bracket	1
4	Boat Mount Right Bracket	1
5	Rubber Mount Gasket	4
6	Mount Piece	2
7	Short Splice	2
8	9x18 Step	1
9	18x24 Platform	1
10	Roof Bar	2
11	Splice Washer - 3/8	4
12	3/8 SHCS x 1.250	4
13	3/8 Washer	12
14	3/8 SHCS x 1.000	10
15	3/8 Locking Nerve/	18
16	3/8 Hex Bolt x 2.50	4
17	Position Pin	4
18	Pin Mounting Bracket	4
19	Position Pin Cable	2
20	Position Pin Cable-2	2
21	10-24 FH-CS x .750	2
22	10-24 Locking Nutnut	4

AMTROL INDUSTRIES, INC. RESERVES THE RIGHT TO MAKE USES OR CHANGE ANY COMPONENTS OF THIS KIT WITHOUT NOTICE AS PROVIDED BY THE COMPANY'S POLICY ON PATENT RIGHTS.